

**STRUCTURAL NOTE:**

- J1= TJI 11 7/8-210
- J2= TJI 11 7/8-560
- B1= 1-LVL 11 7/8 X 1 3/4
- B2= 2-LVL 11 7/8 X 1 3/4
- B3= 3-LVL 11 7/8 X 1 3/4
- B4= 4-LVL 11 7/8 X 1 3/4

- C1=HSS 102X8
- C2=HSS 127X127X8
- C3=3-2X6
- L1=3-2X10
- L2=2-2X10
- L3=2-2X12

- S1= L89X89X7.9
- S2= L152x89x7.9

P1= Precast Conc. Lintel  
as per Manu. Spec

**LEGEND:**

- STONE
- BRICK
- CONC.
- FLOOR DRAIN
- VENT

**NOTE:**

All the exterior doors to be insulated and weather strapped.

PROVIDE 5/8" TYPE "X" DRYWALL ON WEST SIDE ON THE WALLS LESS THAN 4'-0" FROM PROPERTY LINE

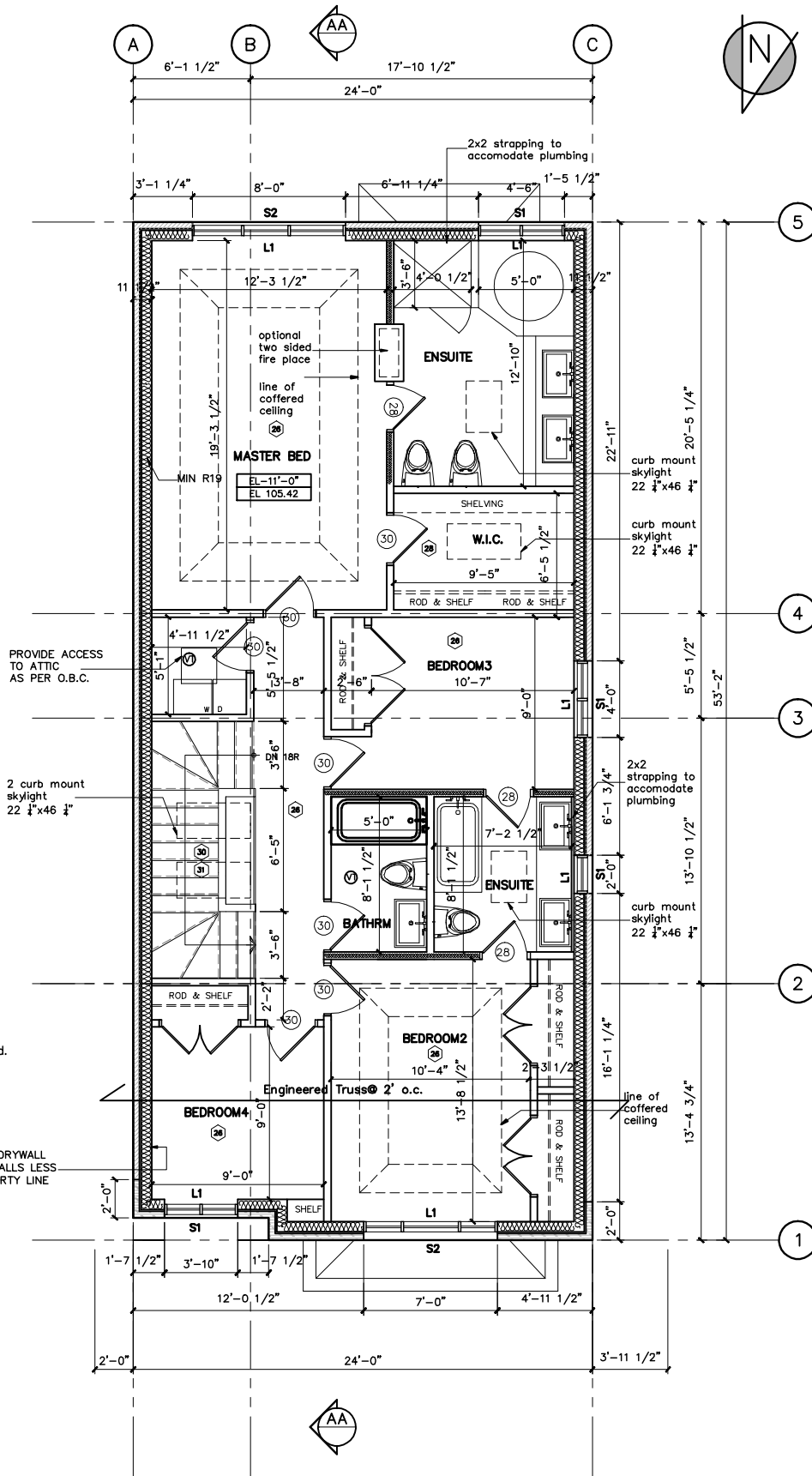

designed by: <b>Ali Shakeri</b> T.416 8166651 F.416 2508900 <b>F &amp; A associates ltd.</b> 29 VIAMDE CRESCENT, M2K 2A7 TORONTO, ONTARIO, CANADA.	project: <b>147 BROOKE AVE.</b>	revisions: 1. ALL WORK SHALL BE CARRIED OUT IN STRICT ACCORDANCE WITH THE REQUIREMENTS OF THE LATEST REVISION OF THE ONTARIO BUILDING CODE. 2. VERIFY ALL DIMENSIONS PRIOR TO CONSTRUCTION. 3. DO NOT SCALE DRAWINGS. 4. ALL DIMENSIONS AND INFORMATION SHALL BE CHECKED AND VERIFIED ON THE JOB AND ANY VARIANCES OR DISCREPANCIES MUST BE REPORTED TO F&A ASSOCIATES BY PHONE AND SUBSEQUENT WRITTEN CONFIRMATION PRIOR TO COMMENCEMENT OF THE WORK. 5. USE ONLY LATEST REVISED DRAWINGS OF THOSE THAT ARE MARKED "ISSUED FOR CONSTRUCTION". 6. ALL STRUCTURAL MEMBERS SHOULD BE REVIEWED AND APPROVED BY CERTIFIED STRUCTURAL ENGINEER PRIOR TO CONSTRUCTION.
	drawing: <b>SECOND FLOOR PLAN</b>	
scale: <b>3/16" = 1'-0"</b>	page: <b>A4</b>	THIS DOCUMENT, SUBMITTED IN CONFIDENCE CONTAINS PROPRIETARY INFORMATION WHICH SHALL NOT BE REPRODUCED OR TRANSFERRED TO OTHER DOCUMENTS OR DISCLOSED FOR CONSTRUCTION OR ANY OTHER PURPOSE WITHOUT THE WRITTEN PERMISSION FROM F&A ASSOCIATES LTD. THIS DOCUMENT SHALL AT ALL TIMES REMAIN THE PROPERTY OF F&A ASSOCIATES.